

140mm

**S001461 Action 4 Unit Swing Set**  
FOR CHILDREN AGED 3 TO 9 YEARS

200mm

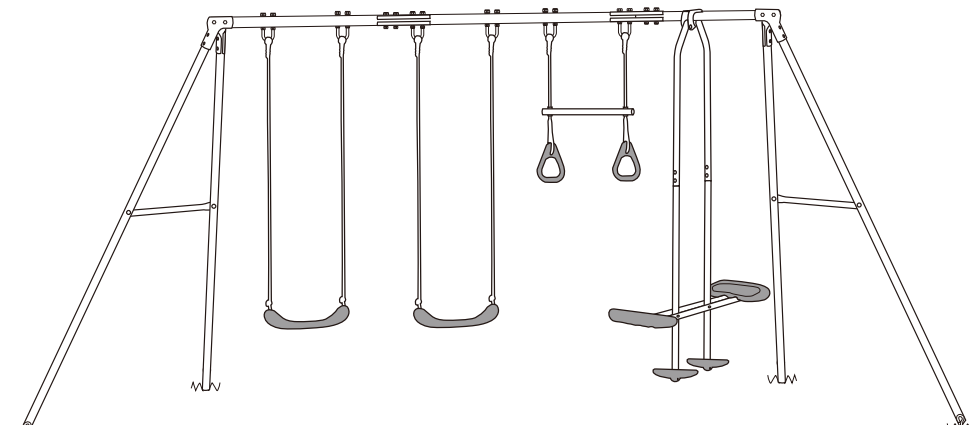

**SAFETY GUIDELINES**

**Warnings**  
Only for domestic use. This product has not been designed for commercial use in play centers, nurseries etc.  
Only suitable for outdoor use.  
The maximum user weight for this product is 34kg per unit/seat. Only one child per seat at any one time. The total weight on the product at any one time must not exceed 170kg.  
Not for children under 3 years due to small component which may cause choking hazard.

This equipment must be assembled and checked by an adult. Two adults may be required to assemble this product. Adult supervision is required at all times.  
Check all nuts and fittings and tighten if required.  
Check all coverings for bolts and sharp edges and replace when required.  
Check swing seats, chain, ropes and other means of attachments for evidence of deterioration.  
Place the product on level surface at least 2 metres from any structure or obstruction such as a fence, garage, house, wall, overhanging branches, laundry line or electrical wires.  
The product MUST be anchored firmly into the ground.  
DO NOT install the product over concrete, asphalt or any hard surface.  
DO NOT orientate the product directly towards the sun.  
Leave all fittings finger tight until assembly is complete, for ease of construction. Then tighten firmly.  
Do not allow children to stand on any swing seats or glider.  
Do not allow the children to jump or climb off any moving equipment.  
Do not twist swing ropes or wrap them over the top bar.  
Do not allow loose, hooded or baggy clothes to be worn as children can get trapped and may be unable to free themselves.  
Do not allow children to climb on parts of this equipment.  
Do not allow children to wander into the play area whilst the equipment is in use.  
Giders and swings must not exceed an angle of 60 degrees from the ground.  
Regularly check the item for wear and damage, removing the item from use when necessary until replacement parts are fitted.  
Failure to assemble and maintain this item as per instruction may cause injury to the user.  
The minimum clearance between the swing and ground level should be 350mm.  
Please do not overtighten nuts and bolts. Use hand tools only.  
Do not use power tools. This can weaken the connection points.  
Please contact our National Service Centre if you require replacement parts (details provided in the warranty page at the back of this manual).  
Please keep the instructions in a safe place for future reference.

**SWING PARTS LIST**

- 1 Top bar A (x1)
- 2 Top bar B (x1)
- 3 Top leg (x4)
- 50 Clamps (x2)
- 5 Bottom Leg(x4)
- 6 Side Stay Bar (x2)
- 51 Brackets (x4)
- 18 Top bar C (x1)
- 8 glider handle tubes (x2)
- 9 glider legs (x2)
- 10 glider seat tubes (x2)
- 11 glider seat (x2)
- 12 glider footrest (x2)
- 13 swing seat (x2)
- 46 Trapeze (x1)
- 47 ground peg A (x4)
- S1 M8 U BOLT (x6)
- G4 M8 BOLT 82mm (x2)
- F1 M8 BOLT 62mm (x4)
- G5 M6 BOLT 40mm (x2)
- F2 M6 BOLT 52mm (x12)
- G6 M6 BOLT 38mm (x8)
- F3 M8 BOLT 67mm (x4)
- G8 THICK PLASTIC SPACER (x4)
- G1 M6 BOLT 47mm (x2)
- G9 THICK PLASTIC SPACER (x4)
- G2 M8 BOLT 39mm (x2)
- G10 M6 BOLT 32mm (x4)

**IMPORTANT:** Make sure you read the safety notice on the front page and always supervise children while they are playing on the equipment. Once assembly is completed carefully check equipment. In the unlikely event that you do find any problems, please contact us. Do not allow children to use this product until the problem has been corrected.

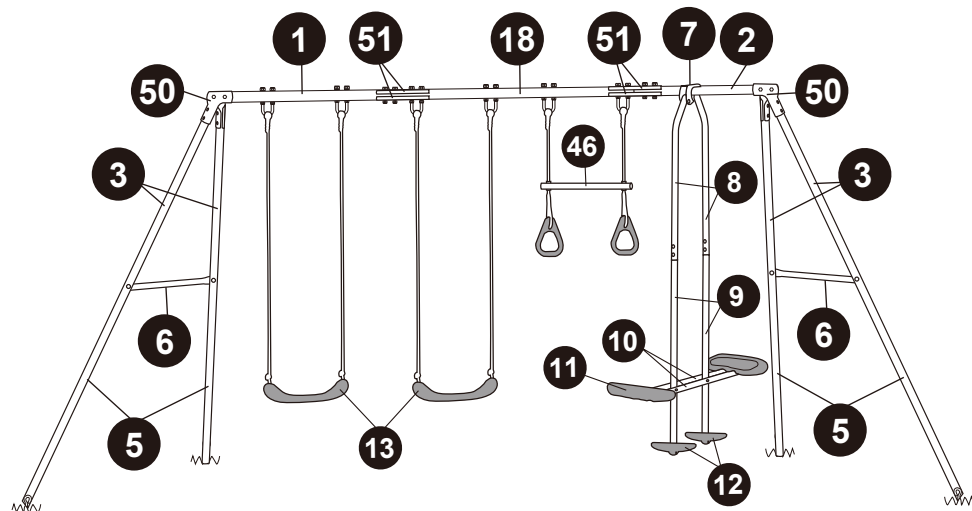

**STEP 1**  
**Frame & Swing Assembly**

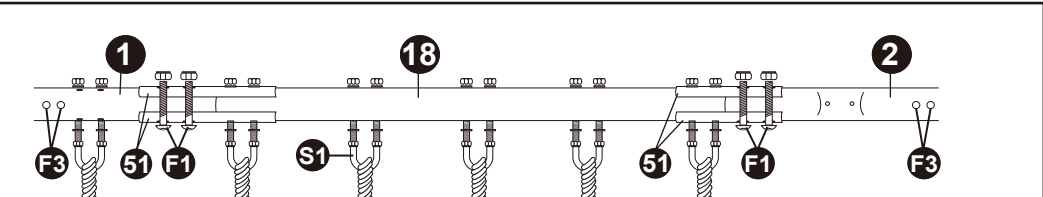
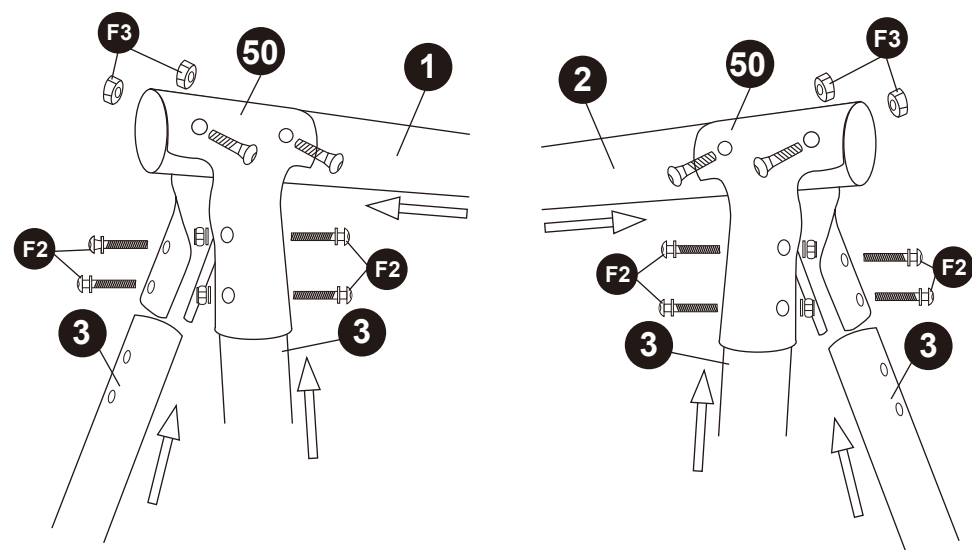

Remember to attach the rope/swing bearing to the U-bolt

**NOTE:** Should the rope come off the rope/swing bearing during use please replace back on top of the rope/swing bearing. Ensure that at least 3 threads from part #S1 protrude from the top.

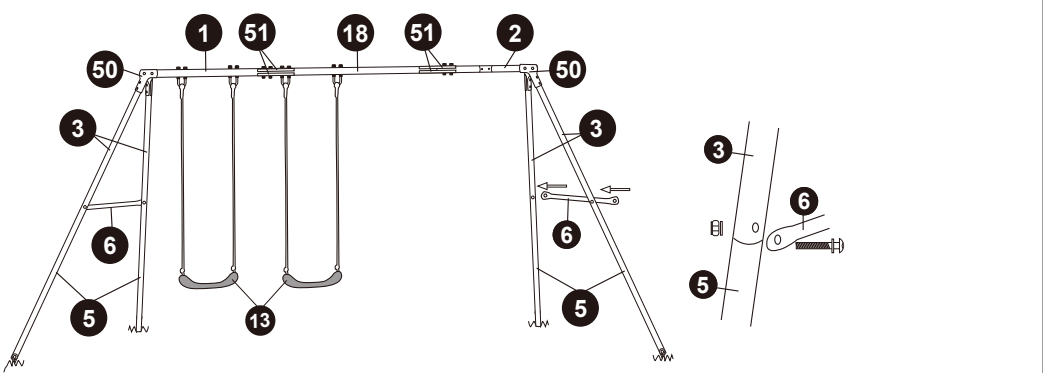

**STEP 2**  
**Glider Assembly**

**WARNING:** The knots on the swings are integral to the safety of the swing. Please ensure they are tight and that the swing is in POSITION 1 as shown in the diagram below. There should be no slack in the rope allowing a loop to form below the swing.

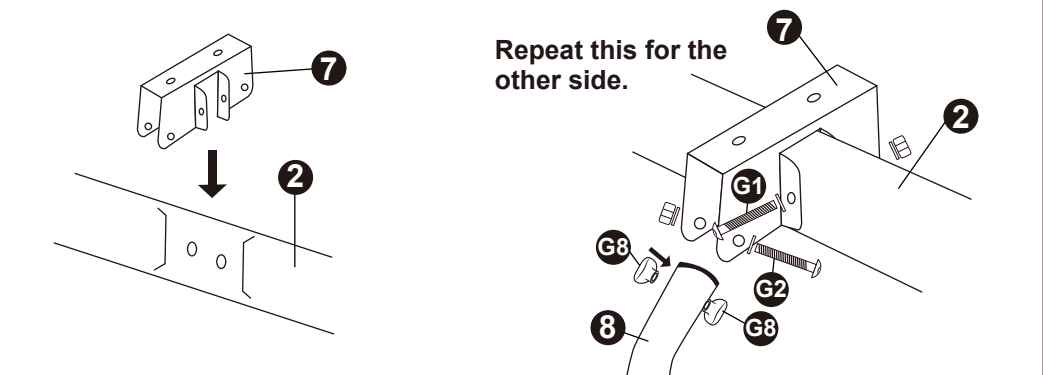

**STEP 3**  
**Anchoring the Swing Set to the Ground**

**IMPORTANT:** For safety reasons this swing set MUST be anchored into the ground. To carry out this procedure you must hammer the included pegs into the ground on the angle shown in the picture below. The peg must pull into hard earth and hold firmly. Attach the swing to the pegs at the connection points shown below. We highly recommend these anchor pegs be concreted, but this is optional. However if ground is soft and peg can easily be pulled out by hand once installed concreting is essential. Contact our service centre for more information.

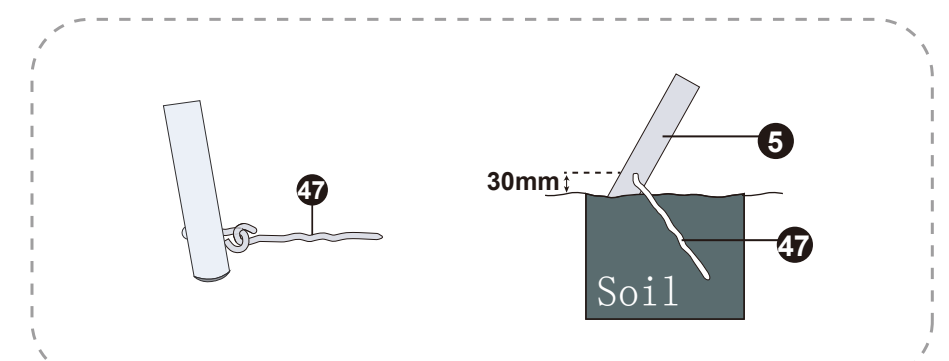
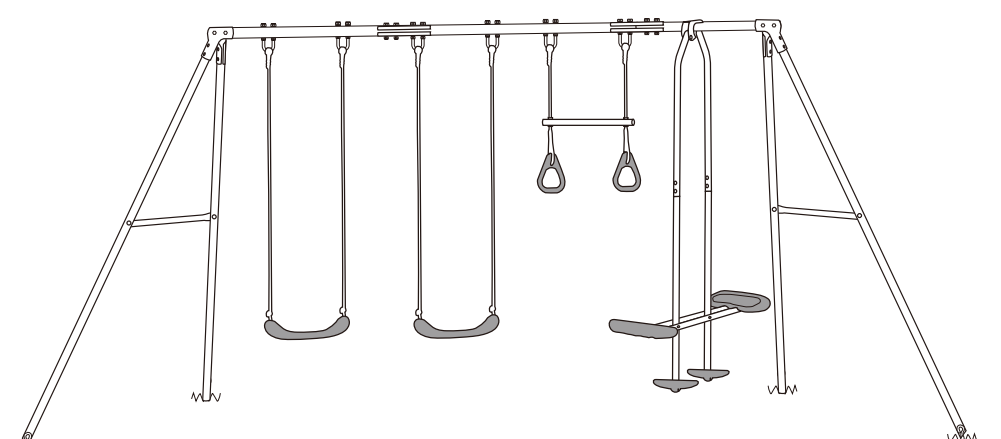

• Assemble seats (11) and attach to seat tubes (10) before tightening bolts (G4)

**WARRANTY INFORMATION**

Congratulations on your purchase!

This **Action 4 Unit Swing Set** is warranted to be free from defects in material and workmanship under normal use and service conditions for a period of **12 months** from the date of purchase of this article. Evidence of unfair usage or incorrect adjustment by the owner will void this promise.

Our goods come with guarantees that cannot be excluded under the Australian Consumer Law. You are entitled to a replacement or refund for a major failure and for compensation for any other reasonably foreseeable loss or damage. You are also entitled to have the goods repaired or replaced if the goods fail to be of acceptable quality and the failure does not amount to a major failure.

**Conditions of Warranty**

All warranty coverage extends only to the original retail purchaser from the date of purchase. Please keep your receipt, tax invoice or other proof of purchase.

This warranty does not extend to any damage to a product caused by abuse, improper or abnormal usage, or repairs not provided by us or our Service Centre. Nor does this warranty extend to products used for commercial or rental purposes. This warranty does not cover ordinary wear, tear and weathering, failure to follow directions, improper installation, improper maintenance or acts of God (such as damage caused by storms, lightning, heavy winds and by snow or ice).

**Making A Warranty Claim**

In order to make a claim under this warranty please direct your enquiries to our Service Centre. You can contact them on our **Freecall 1800 465 070** number or send mail to them at National Service Centre: 6 Sedgwick Street, Smeaton Grange, NSW 2567 – if mailing please include your contact details.

A service representative will then assist you in the appropriate action to be taken. For efficient processing of your enquiry please have proof of purchase, the date of purchase and the retailer name you purchased the item from, and the brand on the product. Photos of the product, and scans of receipts, may be requested to assist with your claim.

The service centre representative will assess the claim. If:

- 1) **There is a minor fault**, they can offer either a replacement spare part, replacement unit, repair or other suitable remedy;
  - 2) **There is a major fault**, they can offer a replacement, repair or suggest you return to the store you purchased it from for a full refund.
- Please note** – a request for compensation will need documentary evidence of the loss or damage suffered. It will also need to be evidenced that such a loss was a reasonably foreseeable result of a failure to comply with a consumer guarantee under the Australian Consumer Law.
- 3) **The product was damaged through abnormal use**, no refund or repair can be offered.

The sending of replacements, spare parts or the cost of repair carried out will be organized and covered by the Service Centre. If collection of the item is required this will be organized by the Service Centre and at our expense. Do not return any products without authorization as this will be at your expense.

Our sales and service centre has been set up to provide assembly assistance, replacement parts and accessories, and to efficiently handle all warranty related matters. Please note upon receiving your warranty claim our Service Centre will send, via post or email, a repair and refurbished goods or parts notice.

**SERVICE CENTRE**  
**Contact details and hours of operation.**

**Freecall 1800 465 070**  
9:00am – 4:30pm Monday to Friday (excluding Public Holidays)  
9:00am – 3:00pm Saturday

**This product is warranted and distributed by Action Sports of 48B Egerton St, Silverwater NSW, 2128. Phone 02 8799 3500**